

Conservatories



A wonderful way to extend your home



Most of us could do with more space and light in our homes - and what better way to achieve this than with a new conservatory?

Conservatories have more benefits than you might think. They don't just provide lots of extra room - our insulation means your new conservatory will retain heat in the winter, and won't be too hot in the summer. So it's a comfortable space for you to enjoy all year round.

And with a variety of styles to choose from - ranging from contemporary to more classic designs - you're sure to find just the right way to bring the garden into your home...and your home into the garden!



Create a unique living space for entertaining or a space to simply relax in after a hard day. A new conservatory can be enjoyed all year round, whatever the occasion or mood.



“Well-insulated, cleverly constructed conservatories, that are comfortable places to relax in, all year round.”

A versatile space for all occasions



Play room, sun room, living room or office - good design and state of the art materials will make your conservatory the perfect place.



2



3

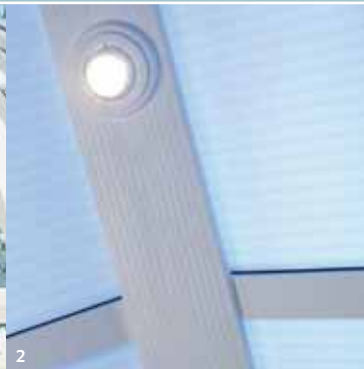

2



4

When choosing your conservatory why not personalise it with furnishings and accessories.

1. Traditional Rod and Boss tie bar
2. Low voltage ridge lighting
3. Ceiling fan
4. Tiled flooring

Deciding which style of conservatory is right for you can be fun - even if it's not always easy.

First you'll want to consider how best to complement your home, and what you really hope to get out of your new room. Will it be a study, perhaps, or a playroom? Or maybe you just want a bit more space to relax...

When it comes to what you want, you're the expert! So once you've thought about your lifestyle, and how a new room can reflect that, we can help you choose the right conservatory.

When it comes to what you want, you're the expert! So once you've given thought to your lifestyle and how your new room can reflect it, simply turn the page - you're sure to be able to find a conservatory that fits your needs.



Choosing your style



Victorian

A popular style distinguished by a faceted front, giving a curved appearance. A particular favourite with period properties, however it's clean lines make this a winner on any type of home.



Georgian

A flat-fronted style that offers excellent use of floor space due to the square or rectangular internal shape. It's sloping roof and contemporary style is suited to the majority of properties.



P-Shape

A P-Shape can combine a Lean-To and a Victorian to create a versatile and visually stunning open space. Due to the proportions needed, this style is better suited to larger properties, giving an impressive result.



T-Shape

As with the P-Shape, this style is more suited to larger properties. A combination style that's distinguished by a central projection that can either be a Victorian, Gable or Georgian. A T-Shape offers a large and versatile floor space and is an impressive addition to any home.

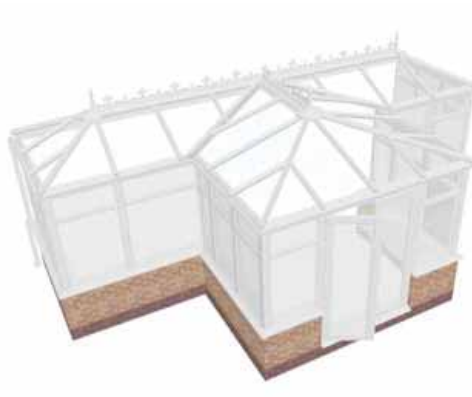

Gable

A gable-fronted conservatory adds a sense of grandeur to any home. Featuring the same rectangular floor space as a Georgian, a gable offers excellent use of internal space. The front panel of the roof remains upright rather than sloping back, to create a feeling of greater height within the conservatory.



Lean-To

For properties with little room under the eaves or for those homeowners that prefer a clean simple look, a Lean-To conservatory is the ideal choice. The pitch of the roof can be varied, making this a versatile and ever-popular option.



Lantern

The 'original' conservatory style, a Lantern ensures drama and grandeur. Distinguished by the two-tiered feature roof, the height within a Lantern adds an extra dimension to the feeling of light and space. A popular choice for swimming pool enclosures.



Custom

Although the shapes and designs shown are all bespoke, you may have your own 'one-off', exceptional or unique idea. The doors, windows and roof systems in this brochure combined with our expertise should allow you achieve that dream.



Whatever the weather



When planning how to make the most of your conservatory, there's a lot to consider - its size, shape, and of course, how much sun it gets.

Our heat reflective glass will ensure you enjoy your conservatory all year round. Its unique coating reflects almost twice as much solar energy as standard glass, and reduces the glare on those bright sunny days.

And because it's designed specifically for British weather, it doesn't just perform in summer. It also has special 'spacer technology' to retain heat and increase the edge temperature by up to 65%, so you can enjoy your new conservatory at just the right temperature - whatever the weather.



The unique coating reflects about 69% of total solar energy. Almost twice as much as standard glass.



Reduce potentially expensive heating bills. Our product outperforms standard glass by more than 50%.



Warm edge spacer technology increases the edge temperature by up to 65%.



This product is a world first, offering true self-cleaning glass that never stops working.



Glare is reduced by 44% all year round compared to standard units.

